

NOTES TO USERS

This map is for use in administering the National Flood Insurance Program. It does not necessarily identify all areas subject to flooding, particularly from local drainage sources of small size. The **community map repository** should be consulted for possible updated or additional flood hazard information.

To obtain more detailed information in areas where **Base Flood Elevations** (BFEs) and/or **floodways** have been determined, users are encouraged to consult the Flood Profiles and Floodway Data and/or Summary of Stillwater Elevations tables contained within the Flood Insurance Study (FIS) report that accompanies this FIRM. Users should be aware that BFEs shown on the FIRM represent rounded whole-foot elevations. These BFEs are intended for flood insurance rating purposes only and should not be used as the sole source of flood elevation information. Accordingly, flood elevation data presented in the FIS report should be utilized in conjunction with the FIRM for purposes of construction and/or floodplain management.

Coastal Base Flood Elevations shown on this map apply only landward of 0.0' North American Vertical Datum of 1988 (NAVD 88). Users of this FIRM should be aware that coastal flood elevations are also provided in the Summary of Stillwater Elevations table in the Flood Insurance Study report for this jurisdiction. Elevations shown in the Summary of Stillwater Elevations table should be used for construction and/or floodplain management purposes when they are higher than the elevations shown on this FIRM.

Boundaries of the **floodways** were computed at cross sections and interpolated between cross sections. The floodways were based on hydraulic considerations with regard to requirements of the National Flood Insurance Program. Floodway widths and other pertinent floodway data are provided in the Flood Insurance Study report for this jurisdiction.

Certain areas not in Special Flood Hazard Areas may be protected by **flood control structures**. Refer to Section 2.4 "Flood Protection Measures" of the Flood Insurance Study report for information on flood control structures for this jurisdiction.

The **projection** used in the preparation of this map was Universal Transverse Mercator (UTM) zone 11. The horizontal datum was NAD83. GPS1990 spheroid. Differences in datum, spheroid, projection or UTM zones used in the production of FIRMs for adjacent jurisdictions may result in slight positional differences in map features across jurisdiction boundaries. These differences do not affect the accuracy of this FIRM.

Flood elevations on this map are referenced to the North American Vertical Datum of 1988. These flood elevations must be compared to structure and ground elevations referenced to the same vertical datum. For information regarding conversion between the National Geodetic Vertical Datum of 1929 and the North American Vertical Datum of 1988, visit the National Geodetic Survey website at <http://www.ngs.noaa.gov/> or contact the National Geodetic Survey at the following address:

NGS Information Services
NOAA, N/NGS12
National Geodetic Survey
SSM-C-3, 49202
1315 East-West Highway
Silver Spring, MD 20910-3282

To obtain current elevation, description, and/or location information for **bench marks** shown on this map, please contact the Information Services Branch of the National Geodetic Survey at (301) 713-3242, or visit its website at <http://www.ngs.noaa.gov/>.

Base map information shown on this FIRM was provided in digital format by the Clark County GIS Management Office (GISMO).

This map reflects more detailed and up-to-date **stream channel configurations** than those shown on the previous FIRM for this jurisdiction. The floodplains and floodways that were transferred from the previous FIRM may have been adjusted to conform to these new stream channel configurations. As a result, the Flood Profiles and Floodway Data tables in the *Flood Insurance Study report* (which contains authoritative hydraulic data) may reflect stream channel distances that differ from what is shown on this map.

Corporate limits shown on this map are based on the best data available at the time of publication. Because changes due to annexations or de-annexations may have occurred after this map was published, map users should contact appropriate community officials to verify current corporate limit locations.

Please refer to the separately printed **Map Index** for an overview map of the county showing the layout of map panels; community map repository addresses; and a Listing of Communities table containing National Flood Insurance Program dates for each community as well as a listing of the panels on which each community is located.

For information and questions about this map, available products associated with this FIRM including historic versions of this FIRM, how to order products or the National Flood Insurance Program in general, please call the FEMA Map Information eXchange at 1-877-FEMA-MAP (1-877-336-2627) or visit the FEMA Map Service Center website at <http://msc.fema.gov>. Available products may include previously issued Letters of Map Change, a Flood Insurance Study Report, and/or digital versions of this map. Many of these products can be ordered or obtained directly from the website. Users may determine the current map date for each FIRM panel by visiting the FEMA Map Service Center website or by calling the FEMA Map Information eXchange.

The Digital Flood Insurance Rate Map (DFIRM) was produced through a unique partnership between Clark County and the Federal Emergency Management Agency (FEMA). Clark County has developed a long-term approach of floodplain management to decrease the costs associated with flooding. This is demonstrated by the Clark County commitment to share and maintain floodplain layers within their Geographic Information System Management Office (GISMO).

This DFIRM reflects several innovative features. These include:

+ Southern Nevada GIS-Cooperation among local government agencies throughout Clark County. The foundation of cooperation is the GIS Interlocal Agreements formed between fourteen regional participants. In part, the agreements specify that the Clark County GIS Management Office (GISMO) will be responsible for maintaining a GIS data warehouse and associated Southern Nevada GIS metadata.

+ The GISMO's responsibilities go beyond maintaining the GIS data warehouse. GISMO also maintains the Street Centerline Database used by 911 dispatch services. This centerline database serves as the base map for this DFIRM.

DIGITAL DATA AVAILABILITY: <http://www.co.clark.nv.us/ceit/gismo/gismo.htm>

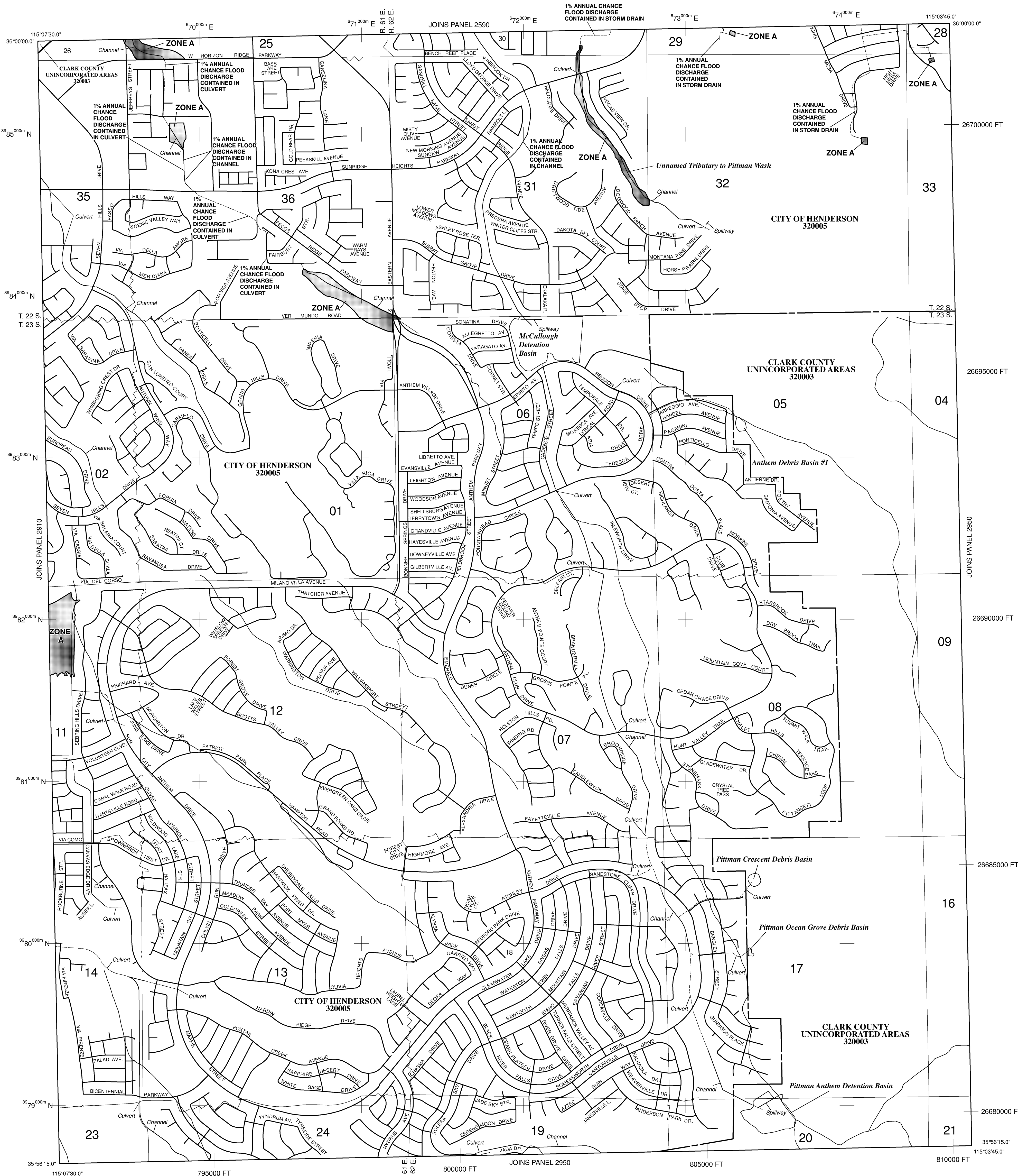
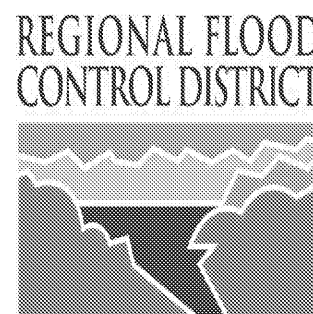

LEGEND

SPECIAL FLOOD HAZARD AREAS (SFHAs) SUBJECT TO INUNDATION BY THE 1% ANNUAL CHANCE FLOOD

The 1% annual chance flood (100-year flood), also known as the base flood, is the flood that has a 1% chance of being equaled or exceeded in any given year. The Special Flood Hazard Area is the area subject to flooding by the 1% annual chance flood. Areas of Special Flood Hazard include Zones A, AE, AH, AO, AR, A99, V and VE. The Base Flood Elevation is the water-surface elevation of the 1% annual chance flood.

ZONE A
No Base Flood Elevations determined.
ZONE AE
Base Flood Elevations determined.
ZONE AH
Flood depths of 1 to 3 feet (usually areas of ponding); Base Flood Elevations determined.
ZONE AO
Flood depths of 1 to 3 feet (usually sheet flow on sloping terrain); average depths determined. For areas of alluvial fan flooding, velocities also determined.
ZONE AR
Special Flood Hazard Area formerly protected from the 1% annual chance flood by a flood control system that was subsequently de-certified. Zone AR indicates that the former flood control system is being restored to provide protection from the 1% annual chance and greater flood.
ZONE A99
Area to be protected from 1% annual chance flood by a Federal flood protection system under construction; no Base Flood Elevations determined.
ZONE V
Coastal flood zone with velocity hazard (wave action); no Base Flood Elevations determined.
ZONE VE
Coastal flood zone with velocity hazard (wave action); Base Flood Elevations determined.

FLOODWAY AREAS IN ZONE AE

The floodway is the channel of a stream plus any adjacent floodplain areas that must be kept free of encroachment so that the 1% annual chance flood can be carried without substantial increases in flood heights.

OTHER FLOOD AREAS

ZONE X
Areas of 0.2% annual chance flood; areas of 1% annual chance flood with average depths of less than 1 foot or with drainage areas less than 1 square mile; and areas protected by levees from 1% annual chance flood.

OTHER AREAS

ZONE X
Areas determined to be outside the 0.2% annual chance floodplain.
ZONE D
Areas in which flood hazards are undetermined, but possible.

COASTAL BARRIER RESOURCES SYSTEM (CBRS) AREAS

OTHERWISE PROTECTED AREAS (OPAs)

CBRS areas and OPAs are normally located within or adjacent to Special Flood Hazard Areas.

Floodplain boundary
Floodway boundary
Zone D boundary
CBRS and OPA boundary
Boundary dividing Special Flood Hazard Areas of different Base Flood Elevations, flood depths or flood velocities
Base Flood Elevation line and value; elevation in feet*
Base Flood Elevation value where uniform within zone; elevation in feet*

* Referenced to the North American Vertical Datum of 1988 (NAVD 88)
Cross section line

Transsect line

Geographic coordinates referenced to the North American Datum of 1983 (NAD 83)
1000-meter Universal Transverse Mercator grid ticks, zone 11
5000-foot grid ticks: Nevada State Plane coordinate system, east zone (FIPSZONE 2701), Transverse Mercator

Bench mark (see explanation in Notes to Users section of this FIRM panel)
River Mile

MAP REPOSITORIES
Refer to Map Repositories list on Map Index

EFFECTIVE DATE OF COUNTYWIDE FLOOD INSURANCE RATE MAP
August 16, 1995
EFFECTIVE DATE(S) OF REVISION(S) TO THIS PANEL
September 27, 2002

November 16, 2011 - to incorporate previously issued Letters of Map Revision, to reflect updated topographic information, to change floodway, to add Base Flood Elevations, to update corporate limits, to change Base Flood Elevations, to add Special Flood Hazard Areas, to change Special Flood Hazard Areas, to delete Special Flood Hazard Areas, to change zone designations, and to add roads and road names.

For community map revision history prior to countywide mapping, refer to the Community Map History table located in the Flood Insurance Study report for this jurisdiction.

To determine if flood insurance is available in this community, contact your insurance agent or call the National Flood Insurance Program at 1-800-638-6620.

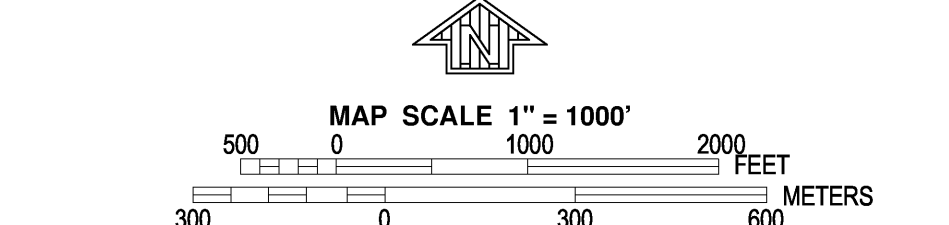

NFIP

PANEL 2930F

FIRM
FLOOD INSURANCE RATE MAP
CLARK COUNTY,
NEVADA
AND INCORPORATED AREAS

PANEL 2930 OF 4090
(SEE MAP INDEX FOR FIRM PANEL LAYOUT)
CONTAINS:

COMMUNITY	NUMBER	PANEL	SUFFIX
CLARK COUNTY	320003	2930	F
HENDERSON, CITY OF	320005	2930	F

Notice to User: The **Map Number** shown below should be used when placing map orders. The **Community Number** shown above should be used on insurance applications for the subject community.



MAP NUMBER
32003C2930F

MAP REVISED
NOVEMBER 16, 2011

Federal Emergency Management Agency