

NOTES TO USERS

This map is for use in administering the National Flood Insurance Program. It does not necessarily identify all areas subject to flooding, particularly from local drainage sources of small size. The **community map repository** should be consulted for possible updated or additional flood hazard information.

To obtain more detailed information in areas where **Base Flood Elevation** (BFEs) and/or **floodways** have been determined, users are encouraged to consult the Flood Profiles and Floodway Data tables contained within the Flood Insurance Study (FIS) report that accompanies this FIRM. Users should be aware that BFEs shown on the FIRM represent rounded whole-foot elevations. These BFEs are intended for flood insurance rating purposes only and should not be used as the sole source of flood elevation information. Accordingly, flood elevation data presented in the FIS should be utilized in conjunction with the FIRM for purposes of construction and/or floodplain management.

**Coastal Base Flood Elevation (BFEs)** shown on this map apply only landward of 0.0' North American Vertical Datum (NAVD). Users of this FIRM should be aware that coastal flood elevations may also be provided in the Summary of Stillwater Elevations table in the Flood Insurance Study report for this community. Elevations shown in the Summary of Stillwater Elevations table should be used for construction, and/or floodplain management purposes when they are higher than the elevations shown on this FIRM.

Boundaries of the **floodways** were computed at cross sections and interpolated between cross sections. The floodways were based on hydraulic considerations with regard to requirements of the National Flood Insurance Program. Floodway widths and other pertinent floodway data are provided in the Flood Insurance Study report for this jurisdiction.

Certain areas not in Special Flood Hazard Areas may be protected by **flood control structures**. Refer to Section 2.4 "Flood Protection Measures" of the Flood Insurance Study report for information on flood control structures in this jurisdiction.

The **projection** used in the preparation of this map is Universal Transverse Mercator (UTM) Zone 11. The **horizontal datum** is NAD83, GRS1980 spheroid. Differences in datum, spheroid, projection or UTM zones used in the production of FIRMs for adjacent jurisdictions may result in slight positional differences in map features across jurisdiction boundaries. These differences do not affect the accuracy of the FIRM.

Flood elevations on this map are referenced to the North American Vertical Datum of 1988. These flood elevations must be compared to structure and ground elevations referenced to the same **vertical datum**. For information regarding conversion between the National Geodetic Vertical Datum of 1929 and the North American Vertical Datum of 1988, visit the National Geodetic Survey website at [www.ngs.noaa.gov](http://www.ngs.noaa.gov) or contact the National Geodetic Survey at the following address:

Vertical Network Branch, N/C613  
National Geodetic Survey, NOAA  
Silver Spring Metro Center 3  
1315 East-West Highway  
Silver Spring, Maryland 20910  
(301) 713-3191

To obtain current elevation, description, and/or location information for **bench marks** shown on this map, please contact the Information Services Branch of the National Geodetic Survey at **(301) 713-3242**, or visit their website at [www.ngs.noaa.gov](http://www.ngs.noaa.gov).

**Base map** information shown on this FIRM was provided in digital format by Clark County Regional Flood Control District. This information was converted using Orthophotography, dated 1999 or newer, and GBF/DIME data. Segments were digitized off of the orthophotography based on center of pavement.

**Corporate limits** shown on this map are based on the best data available at the time of publication. Because changes due to annexations or de-annexations may have occurred after this map was published, map users should contact appropriate community officials to verify current corporate limit locations.

Please refer to the separately printed **Map Index** for an overview map of the county showing the layout of map panels; community map repository addresses; and a Listing of Communities table containing National Flood Insurance Program dates for each community as well as a listing of the panels on which each community is located.

An accompanying Flood Insurance Study report, Letters of Map Revision or Letters of Map Amendment revising portions of this panel, and digital versions of this PANEL may be available. Contact the **FEMA Map Service Center** at the following phone numbers and Internet address for information on all related products available from FEMA:

Phone: 800-358-9616  
FAX: 800-358-9620  
[www.fema.gov/msc](http://www.fema.gov/msc)

If you have **questions about this map** or questions concerning the National Flood Insurance Program in general, please call **1-877-FEMA-MAP** (1-877-336-2627) or visit the FEMA website at [www.fema.gov](http://www.fema.gov).

This map reflects more detailed and up-to-date stream channel configurations than those shown on the previous FIRM for this jurisdiction. The floodplains and floodways that were transferred from the previous FIRM may have been adjusted to conform to these new stream channel configurations. As a result, the Flood Profiles and Floodway Data tables in the Flood Insurance Study report may reflect stream channel distances that differ from what is shown on this map.

This Digital Flood Insurance Rate Map (DFIRM) was produced through a unique partnership between Clark County and the Federal Emergency Management Agency (FEMA). Clark County has developed a long-term approach of floodplain management to decrease the costs associated with flooding. This is demonstrated by the Clark County commitment to share and maintain floodplain layers within their Geographic Information System Management Office (GISMO).

This DFIRM reflects several innovative features. These include:  
+ Southern Nevada GIS-- Cooperation among local governmental agencies throughout Clark County. The foundation of cooperation is the GIS Interlocal Agreements formed between fourteen regional participants. In part, the agreements specify that the Clark County GIS Management Office (GISMO) will be responsible for maintaining a GIS data warehouse and associated Southern Nevada GIS Metadata.

+ The GISMO's responsibilities go beyond maintaining the GIS data warehouse. GISMO also maintains the Street Centerline Database used by 911 dispatch services. This centerline database serves as the base map for this DFIRM.

DIGITAL DATA AVAILABILITY: <http://www.co.clark.nv.us/ceit/gismo/gismo.htm>

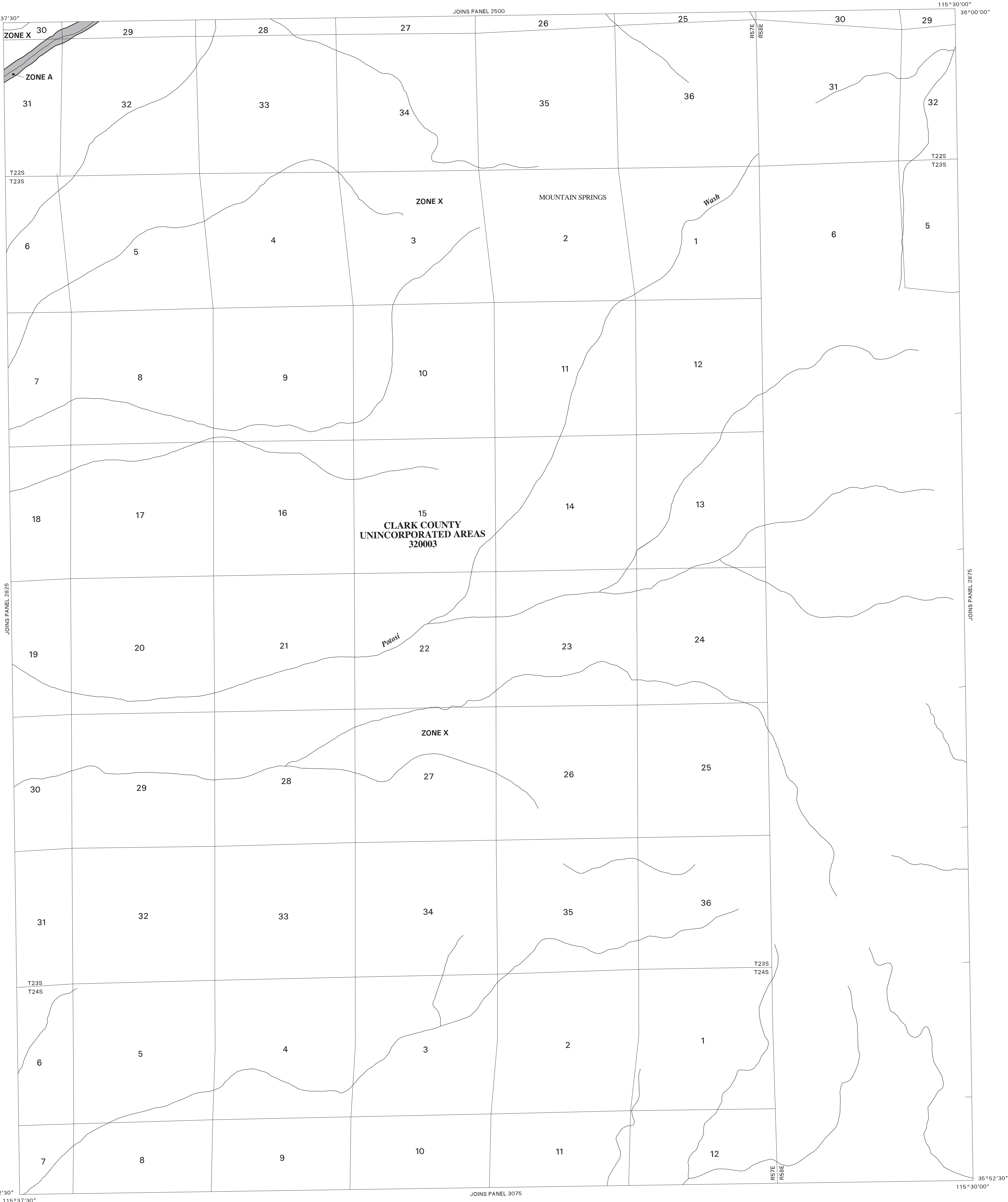

LEGEND

SPECIAL FLOOD HAZARD AREAS SUBJECT TO INUNDATION BY THE 1% ANNUAL CHANCE FLOOD EVENT

The 1% annual chance flood (100-year flood), also known as the base flood, is the flood that has a 1% chance of being equalled or exceeded in any given year. The Special Flood Hazard Area is the area subject to flooding by the 1% annual chance flood. Areas of Special Flood Hazard include Zones A, AE, AH, AO, AR, A99, V, and VE. The Base Flood Elevation is the water surface elevation of the 1% annual chance flood.

- ZONE A** No base flood elevations determined.
- ZONE AE** Base flood elevations determined.
- ZONE AH** Flood depths of 1 to 3 feet (usually areas of ponding); base flood elevations determined.
- ZONE AO** Flood depths of 1 to 3 feet (usually sheet flow on sloping terrain); average depths determined. For areas of alluvial fan flooding, velocities also determined.
- ZONE AR** Area of special flood hazard formerly protected from the 1% annual chance flood event by a flood control system that was subsequently decertified. Zone AR indicates that the former flood control system is being restored to provide protection from the 1% annual chance or greater flood event.
- ZONE A99** Area to be protected from 1% annual chance flood event by a Federal flood protection system under construction; no base flood elevations determined.
- ZONE V** Coastal flood zone with velocity hazard (wave action); no base flood elevations determined.
- ZONE VE** Coastal flood zone with velocity hazard (wave action); base flood elevations determined.

FLOODWAY AREAS IN ZONE AE

The floodway is the channel of a stream plus any adjacent floodplain areas that must be kept free of encroachment so that the 1% annual chance flood can be carried without substantial increases in flood heights.

OTHER FLOOD AREAS

**ZONE X** Areas of 0.2% annual chance flood; areas of 1% annual chance flood with average depths of less than 1 foot or with drainage areas less than 1 square mile; and areas protected by levees from 1% annual chance flood.

OTHER AREAS

**ZONE X** Areas determined to be outside the 0.2% annual chance floodplain.

**ZONE D** Areas in which flood hazards are undetermined, but possible.

COASTAL BARRIER RESOURCES SYSTEM (CBRS) AREAS

OTHERWISE PROTECTED AREAS (OPAs)

CBRS areas and OPAs are normally located within or adjacent to Special Flood Hazard Areas.

- Floodplain Boundary
- Floodway Boundary
- Zone D Boundary
- Coastal Barrier Boundary
- Boundary dividing Special Flood Hazard Areas of different Base Flood Elevations, flood depths or velocities.
- Base Flood Elevation line and value; elevation in feet\*
- Base Flood Elevation value where uniform within zone; elevation in feet\*

\*Referenced to the North American Vertical Datum of 1988

- Cross Section Line
- Transsect Line
- Geographic coordinates referenced to the North American Datum of 1983 (NAD 83)
- 1000-meter Universal Transverse Mercator grid values, zone 11
- 5000-foot grid ticks

Bench mark (see explanation in Notes to Users section of this FIRM panel).

River Mile

MAP REPOSITORY  
Refer to Repository Listing on Index Map

EFFECTIVE DATE OF COUNTYWIDE  
FLOOD INSURANCE RATE MAP  
AUGUST 16, 1995

EFFECTIVE DATE(S) OF REVISION(S) TO THIS PANEL

September 27, 2002: to update corporate limits, to change base flood elevations, to add base flood elevations, to add special flood hazard areas, to change special flood hazard areas, to delete special flood hazard areas, to change zone designations, to add roads and road names, to incorporate previously issued letters of map revision, to incorporate previously issued letters of map amendment, and to change floodway.

For community map revision history prior to countywide mapping, refer to the Community Map History table located in the Flood Insurance Study report for this jurisdiction.

To determine if flood insurance is available in this community, contact your insurance agent or call the National Flood Insurance Program at (800) 636-6620.

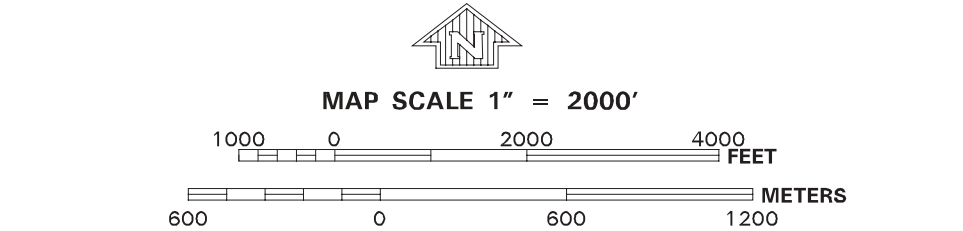

NATIONAL FLOOD INSURANCE PROGRAM

FEDERAL EMERGENCY MANAGEMENT AGENCY

PANEL 2850 E

FIRM

FLOOD INSURANCE RATE MAP

CLARK COUNTY,

NEVADA AND

INCORPORATED AREAS

PANEL 2850 OF 4090

(SEE MAP INDEX FOR FIRM PANEL LAYOUT)

CONTAINS:

COMMUNITY	NUMBER	PANEL	SUFFIX
CLARK COUNTY, UNINCORPORATED AREAS	320003	2850	E

Notice to User: The Map Number shown below should be used when placing map orders. The Community Number shown above should be used on insurance applications for the subject community.

FEDERAL EMERGENCY MANAGEMENT AGENCY

MAP NUMBER

32003C2850 E

MAP REVISED:

SEPTEMBER 27, 2002

Federal Emergency Management Agency